

- 45. Blade
- 46. Centering flange
- 47. Adjusting washer
- 48. Hex soc screw M6X8
- 49. Hexagonal bolt M6X20
- 50. Washer 6mm
- 51. Turning tang
- 52. Indicator-height
- 53. Setting tang bolt
- 54. Hexagonal bolt M6X16

- 55. Washer 6mm
- 56. Hexagonal nut M6
- 57. Handwheel/blade rise&fall
- 58. Washer 10mm
- 59. Thread rod support
- 60. Ring retaining
- 61. Thread rod
- 62. Ring retaining
- 63. Thread rod nut
- 64. Washer 6mm

- 65. Guide plan
- 66. Spring washer
- 67. Chipcase
- 68. Motor
- 69. Pan head screw M4X13
- 70. Pan head tapping screw ST3.5X13
- 71. Dust collector
- 72. Motor carrier unit
- 73. Self-plugging rivet
- 75. Thread rod seat

- 76. Riving knife seat
- 77. Carriage bolt M10X25
- 78. Guide plate
- 79. Lever
- 80. Riving knife
- 81. "U" plate
- 82. Thread rod support
- 83. Hexagonal nut self-lock M10
- 84. Tightening flange blade
- 85. Left side nut
- 86. Cover for chipcase (lower)
- 87. Cover for chipcase (upper)

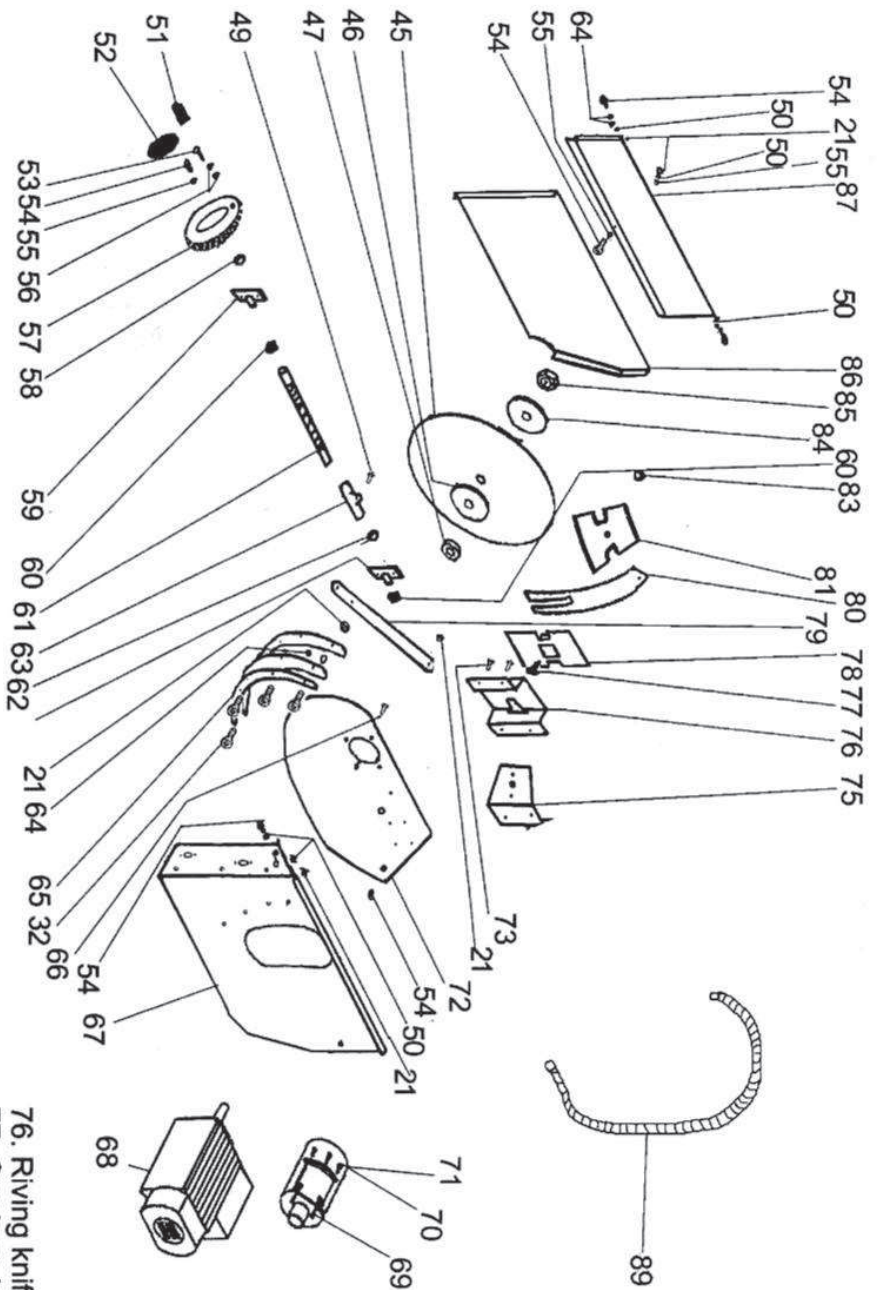

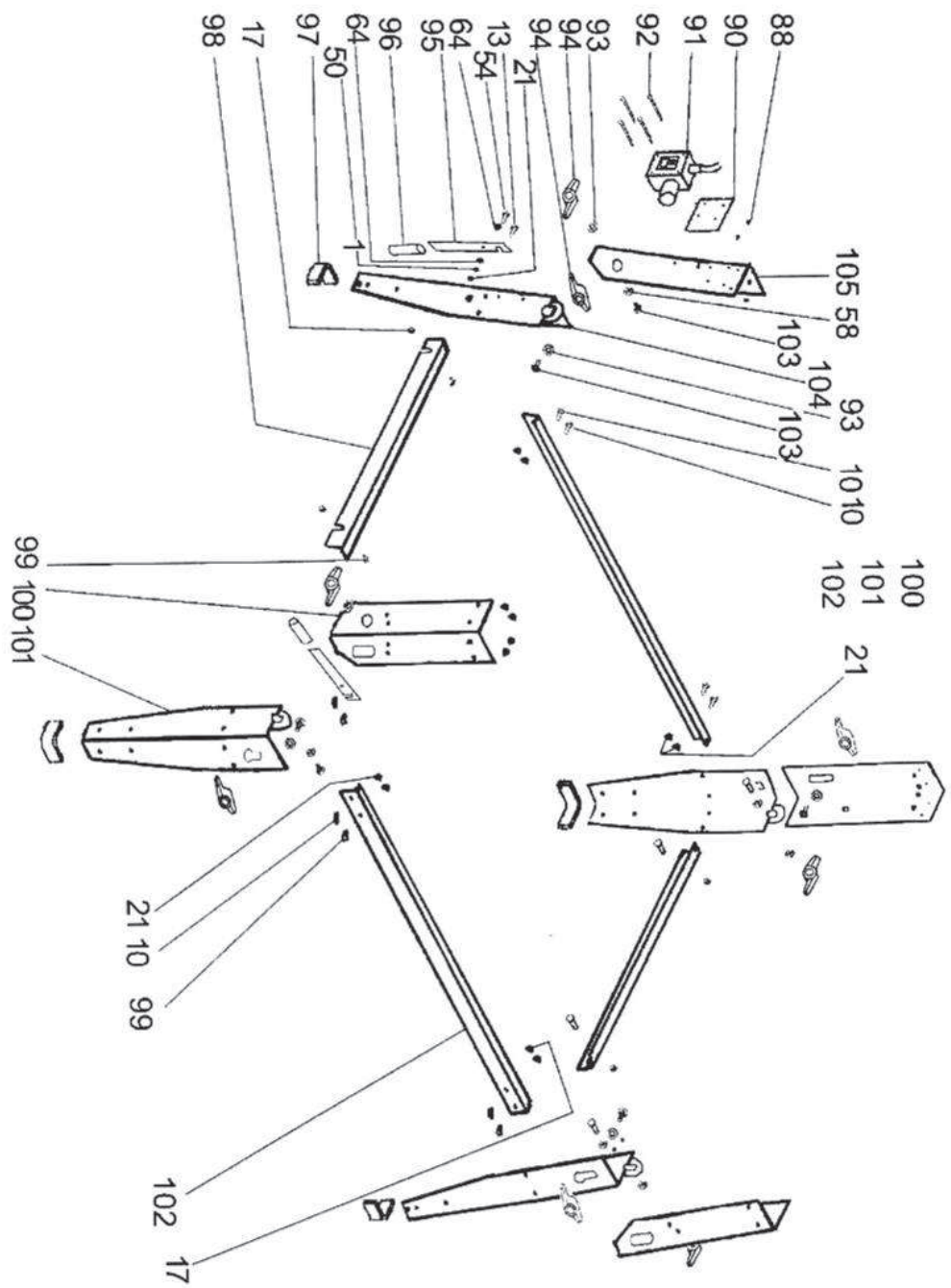

- 88. Hexagonal nut self-lock M4
- 89. Suction hose
- 90. Switch bracket
- 91. Switch
- 92. Pan head screw M4X60
- 93. Washer 8mm
- 94. Wing nut
- 95. Handle
- 96. Rubber handle
- 97. Rubber feet
- 98. Short crossbeam
- 99. Carriage bolt M4X60
- 100. Upper fold leg (right)
- 101. Lower fold leg (right)
- 102. Short crossbeam
- 103. Carriage bolt M8X16
- 104. Upper fold leg (left)
- 105. Lower fold leg (left)

Lombarte Group

Cardona, 55
E-08203 Sabadell – EU
Tel. 93 727 00 51
Fax 93 727 40 57